

# PROJECT PROPOSAL

FLOW

# CHOSEN TOPIC

This project is a dynamic and interactive representation of the LCC community, where each individual, whether a student, teacher, or staff member, contributes to the creation of a unique portrait.

As individuals pass by the sensor or web camera, new lines are added, reflecting the continuous growth of our community. The culmination of these lines at the end of each day results in a unique abstract artwork, a testament to the collective identity of the LCC community.

We propose to present these artworks on a dedicated showcase website, allowing a wider audience to appreciate the beauty of our community's diversity and unity. This project not only represents the LCC community but also embodies the spirit of inclusivity and collaboration that we stand for.

ROUGH SKETCH

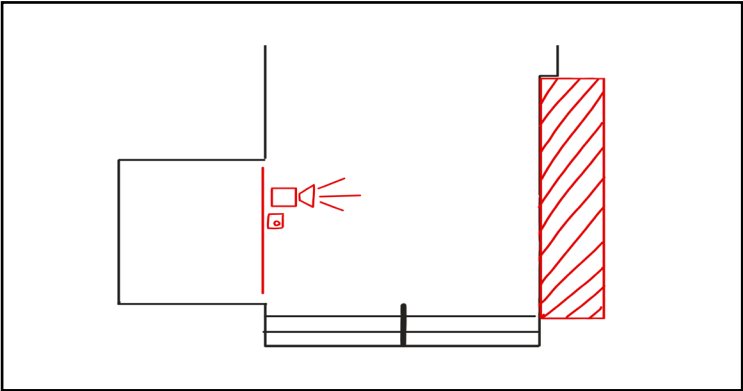

## **GROWTH AND REPETITION**

The artwork is a projection on the wall, composed of lines, with each line representing an individual from the LCC community. The position of each line is determined by the height of the person, as the camera tracks the head and maps the movement of the individual. This creates a unique abstract artwork that is renewed every day, symbolizing the growth and repetition that are the themes of the exhibition.

# CONCEPT SKECTH

[Link 1](#)

